

IR20

BIG AND VERSATILE

INPUT

Power supply	[50HzThree-phases+N+GND]	400 V a.c.
Pneumatic power (min.)	[bar]	5
Max. power required (peak load)	[kW]	28
Power consumption	[kWh]	

OUTPUT

PP equivalent welding area ¹	[cm ²]	
Heating zones		16 (up to 20)
Total power (up to)	[W]	

CONTROL

PLC Control		ET200 SP Open Controller
HMI		PC panel 15"
Welding steps (pressure, amplitude)		8
Welding depth sensitivity	[mm]	0,05
Work settings memory	[mm]	up to 63 automatic equipment
Type of communication ³		Profinet

REFERENCES

Noise level ²	[dBA EN ISO 11202]	≤ 75
Work outcome definition		Automatic (good/reject)
Vacuum circuit		1 (opt. up to 4)
Pneumatic valves movements		6 (opt. up to 8)
Remote-assistance		Optional

¹Size of the area detected in the test environment.

²Peak values can be higher for short periods depending on the application.

The information contained in this document is the property of CEMAS Elettra srl and is protected by copyright. Reproduction, distribution, or use of this document, even in part, without the prior written permission of CEMAS Elettra srl is prohibited. The information provided is for informational purposes only and is subject to change without notice. CEMAS Elettra srl assumes no responsibility for any errors or inaccuracies contained in this document.



Infrared welding fuses thermoplastic materials by utilizing heat radiation, offering a precise, controlled and contactless joining method.

BIG AND VERSATILE
Same standards of precision and power for welding large and oversized components.

MORE INFO



YOUR PARTNER
IN PLASTIC JOINING

The machine can be customized with some standard options. Contact us for personalized offer.

Infrared Welding Strong Points

Design flexibility
Memory storage
Efficient electric operation
High precision
Energy-saving
Smart power transmission
Clean, non-contact
Modular design
Aesthetic focus

Starting from 2007, CEMAS ELETTRA has developed different infrared applications. Currently infrared is one of our best-seller technologies, further proof of the reliability of our machines. Full electric machines allow the complete control of all the welding parameters, monitoring and instantaneously changing pressure, heating and speed values of the press. The electric movements assure repetitiveness, accuracy and fluidity in welding process.

MORE INFO



YOUR PARTNER
IN PLASTIC JOINING

MECHANICAL DATA

Head table dimensions	[mm]	2105 x 800
Upper tool plate dimensions	[mm]	2000 x 800
Lifting table stroke	[mm]	605+610
Lifting table maximum speed	[mm/s]	500
Clamp net force (gross)	[kN]	20 (24,3)
Lifting table dimensions	[mm]	2105 x 800
Lower tool plate dimensions	[mm]	2000 x 800
Lifting table height	[mm]	560
Mirror plate dimensions	[mm]	1960 x 780
Front-door span	[mm]	2180 x 1000
Upper door threshold	[mm]	1770
Clearance between planes	[mm]	280/1495
Overall dimensions (WxDxH)	[mm]	2535 x 3100 x 2555
Total weight	[kg]	5000
Machine type		Full electric

UPPER PLATE

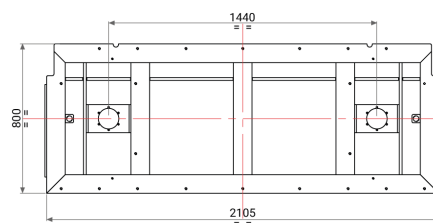

LOWER PLATE

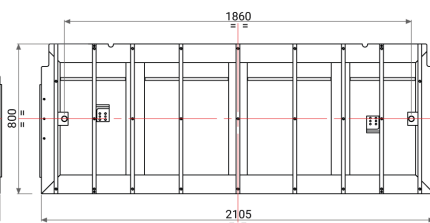

OVERALL DIMENSIONS

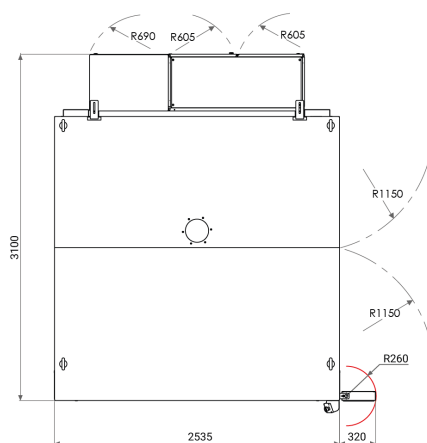
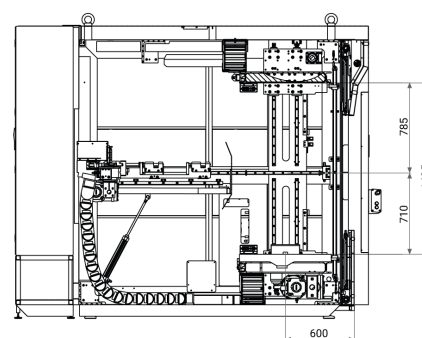
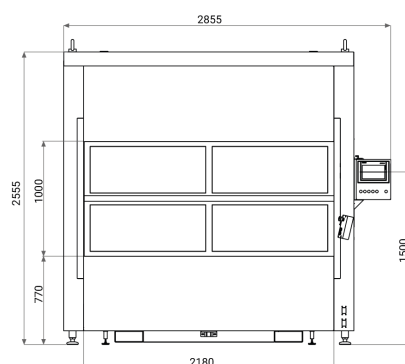

The information contained in this document is the property of CEMAS Elettra srl and is protected by copyright. Reproduction, distribution, or use of this document, even in part, without the prior written permission of CEMAS Elettra srl is prohibited. The information provided is for informational purposes only and is subject to change without notice. CEMAS Elettra srl assumes no responsibility for any errors or inaccuracies contained in this document.

